

APPENDIX C.6 | HISTORICAL INFORMATION



Parks, Recreation, and Historic Preservation

Resource Evaluation

Date: 05/28/2020

Staff: Chelsea Towers

USN Number: 02714.000601

Name: Schatz Ball Bearing Co.

Location: 60 Fairview Ave, Poughkeepsie NY 12601

Resource Status:

1. **Determination:** Determined SR/NR eligible by the Commissioner of the Office of Parks, Recreation and Historic Preservation on the date noted above.
2. **Contributing:**

Criteria for Inclusion in the National Register:

- A. ☒ Associated with events that have made a significant contribution to the broad patterns in our history.
- B. ☐ Associated with the lives of persons significant in our past.
- C. ☐ Embodies the distinctive characteristics of a type, period or method of construction; or represents the work of a master; or possesses high artistic values; or represents a significant and distinguishable entity whose components may lack individual distinction.
- D. ☐ Have yielded, or may be likely to yield information important in prehistory or history.

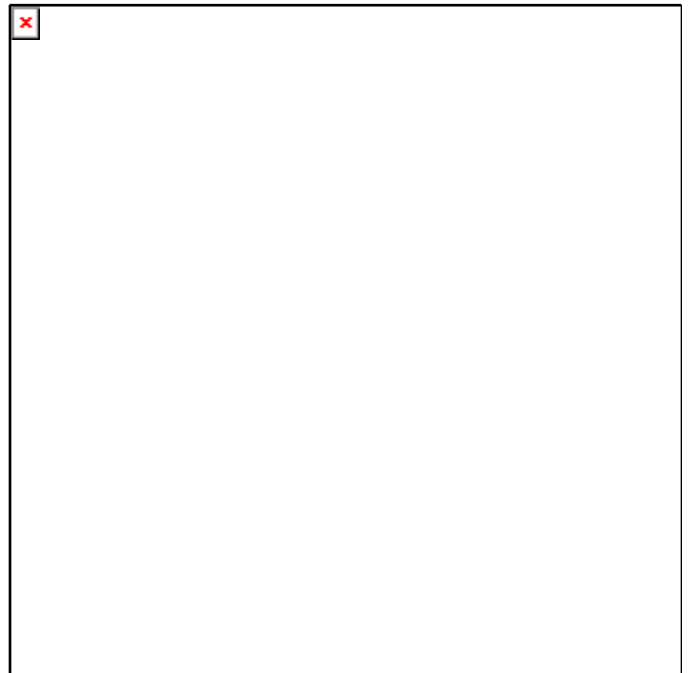

Summary Statement:



The Schatz Ball Bearing Co. property is eligible for the State and National Registers under Criterion A in the area of industry as an important manufacturing site for ball bearings and one of the largest employers in Poughkeepsie. The company was founded in 1895 by father and son, Adolf and Herrman Schatz, in New Haven Connecticut. By 1910, the company purchased and moved to a single-story building on Fairview Ave in Poughkeepsie with 75 employees. Five years later Schatz organized Federal Bearing Co to manufacture high grade ball bearings, and for the next four decades the company continued to expand. Significant additions to the facility were completed in 1916, 1920, 1926, 1936, and 1942 as the employee count continued to rise. The company held competitive contracts in the automobile industry, including those with Ford and NAPA Auto Parts, and by the early 1940s a record 1,200 employees work at the Fairview Ave site. While the company continued to thrive through the 70s, a 15-month employee strike in late 1960s lost them their momentum and by 1979 the NAPA contract closed. After 70 years of operation at the Schatz Federal Bearing site, the company filed for bankruptcy and closed its doors in 1980. Today the Fairview Ave manufacturing site is a physical intact reminder of the Schatz Ball Bearing Corporation's growth and success.

Further study/documentation, unavailable at this time, may suggest additional areas of significance.

77



BUILDING-STRUCTURE INVENTORY FORM

NYS OFFICE OF PARKS, RECREATION
& HISTORIC PRESERVATION
DIVISION FOR HISTORIC PRESERVATION
(518) 474-0479

FOR OFFICE USE ONLY

UNIQUE SITE NO. _____
QUAD _____
SERIES _____
NEG. NO. _____

P.O. Box 88
Poughkeepsie, NY 12602
914-471-1630
Dutchess County Historical Society

DATE: _____

EPHONE: _____

IDENTIFICATION

1. BUILDING NAME(S): _____
2. COUNTY: Dutchess TOWN/CITY: Poughkeepsie VILLAGE: _____
3. STREET LOCATION: HAMILTON ST
4. OWNERSHIP: a. public ☐ b. private ☒
5. PRESENT OWNER: _____ ADDRESS: _____
6. USE: Original: FACTORIES (BAL BEARINGS?) Present: IN INDUSTRIAL COMPLEX
7. ACCESSIBILITY TO PUBLIC: Exterior visible from public road: Yes ☒ No ☐
Interior accessible: Explain _____

DESCRIPTION

8. BUILDING MATERIAL: a. clapboard ☐ b. stone ☐ c. brick ☒ d. board and batten ☐
e. cobblestone ☐ f. shingles ☐ g. stucco ☐ other: _____
9. STRUCTURAL SYSTEM: (if known) a. wood frame with interlocking joints ☐
b. wood frame with light members ☐
c. masonry load bearing walls ☒
d. metal (explain) _____
e. other _____
10. CONDITION: a. excellent ☐ b. good ☐ c. fair ☒ d. deteriorated ☐
11. INTEGRITY: a. original site ☒ b. moved ☐ if so, when? _____
c. list major alterations and dates (if known):
MULTIPLE NEW ADDITIONS AND SEVERAL NEW BLDGS. HAVE BEEN ADDED

12. PHOTO:

13. MAP:

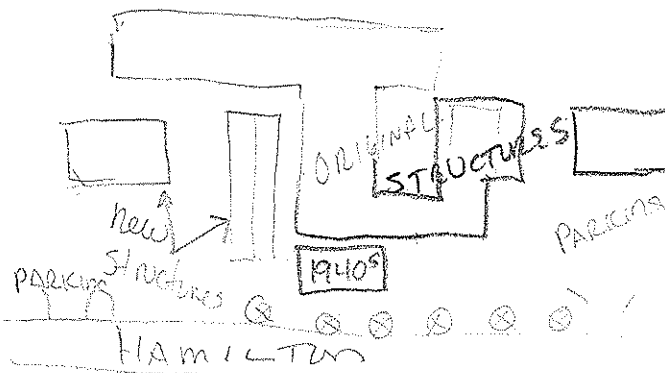

79

14. THREATS TO BUILDING: a. none known ☒ b. zoning ☐ c. roads ☐
d. developers ☐ e. deterioration ☐
f. other: _____
15. RELATED OUTBUILDINGS AND PROPERTY:
a. barn ☐ b. carriage house ☐ c. garage ☐
d. privy ☐ e. shed ☐ f. greenhouse ☐
g. shop ☐ h. gardens ☐
i. landscape features: multiple outbldg.
j. other: _____
16. SURROUNDINGS OF THE BUILDING (check more than one if necessary):
a. open land ☐ b. woodland ☐
c. scattered buildings ☐
d. densely built-up ☐ e. commercial ☐
f. industrial ☒ g. residential ☒
h. other: _____
17. INTERRELATIONSHIP OF BUILDING AND SURROUNDINGS:
(Indicate if building or structure is in an historic district)
to the east is residential and to the west is industrial zoning
18. OTHER NOTABLE FEATURES OF BUILDING AND SITE (including interior features if known):

SIGNIFICANCE

19. DATE OF INITIAL CONSTRUCTION: 1920 / 1940's / 1960's

ARCHITECT: _____

BUILDER: _____

20. HISTORICAL AND ARCHITECTURAL IMPORTANCE:

Some Deco style

21. SOURCES:

22. THEME:

